

Datasheet

Description

Blindflange, ANSI/ASME B16.5, RF, 150lbs, A105N, certificate 3.1

Main data

DN1 1/4"

D	115.00 mm
H2	16.00 mm
L	4 x 16.00 mm

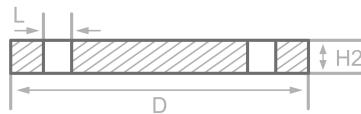

Chemical analysis (heat) in % of mass

(one content=max. value)

Short name: A105N

Mat. grade: -----

C	Si	Mn	P	S	Cr	Cu	Mo	Nb	Ni	Ti	V	Others
0.35	0.35	1.35	0.04	0.05								

Mechanical properties

Short name: A105N

Mat. grade: -----

Upper yield strength reH or Rp0.2 min for wallthicknesses T in mm, N/mm2 at room temperature		Tensile strength Rm for wallthickn. T in mm, N/mm2 at room temperature		Elongation A at room- temperature, min.%		Min. impact energy KV in J	
T<=16	16<T<=60	T<=16	16<T<=60	Longit.	Transv.	Longit.	Transv.
250	250	485	485	30			

Sources: EN 10253, DIN 17175, DIN 2528, DIN 1629, Stahlschlüssel, ASTM

